

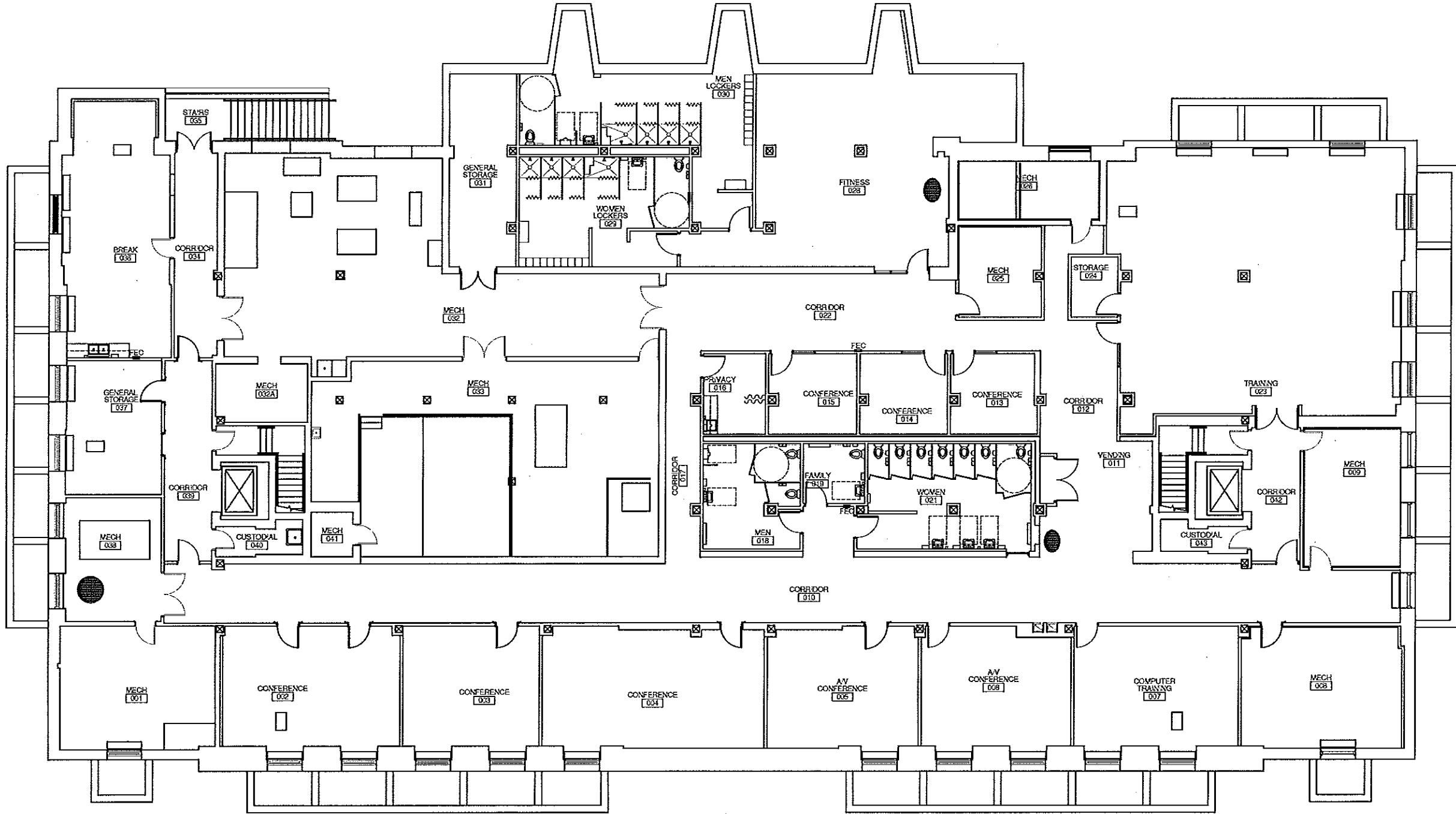

Sump Pit Locations



SHEET NO.	A1.00	OF	FILE NAME	G251050	NO.	REVISION	DATE
<p style="text-align: center;">AMENT, INC. Engineering, Architecture, Surveying Cedar Rapids - Waterloo, Iowa & Malibu - Mount Prospect, Illinois</p>							
<p style="text-align: center;">BASEMENT FLOOR PLAN CITY HALL 101 1ST STREET SE CEDAR RAPIDS, IA</p>							
<p style="text-align: center;">DRAWN BY: SKD APPROVED BY: AMV3 DATE: 06/10/2011</p>							